

USER MANUAL

Automatic Soap Dispenser

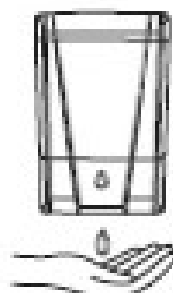

please read user manual carefully before using

SPECIFICATION

Overall size	L110*W100*H165mm
Vol	600ml
Liquid dosage	1ml/time
Unit materials	ABS AS
Battery type	4pcs "AA"alkaline
VOLT	DC 6V
Working current	120mA
Standby current	60uA
Sensor range	0-10CM
Low battery	4.2V

FEATURES

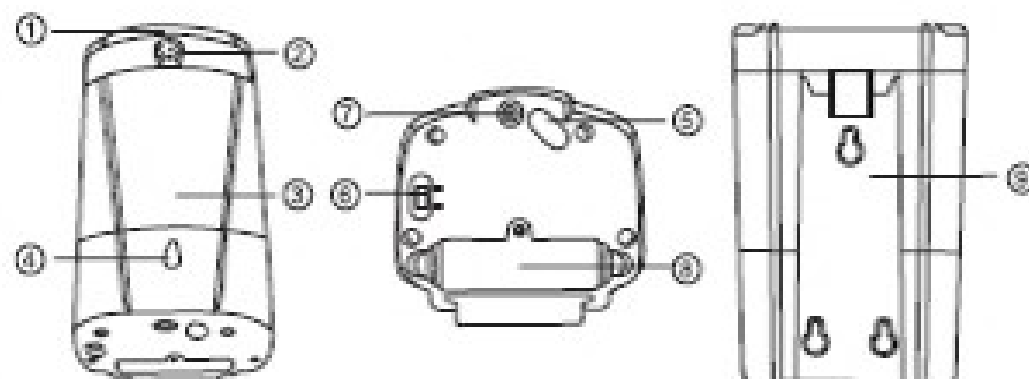

① Top lid

② Lock

③ Soap tank

④ LED light

⑤ Infrared sensor

⑥ Power switch

⑦ Liquid outlet

⑧ Battery chamber

⑨ Mounting plate

INSTALLATION AND OPERATION

Choose a suitable place to install this dispenser, do not install it on the mirror surface and keep 40CM free space from Sensor

1. Take out the mounting plate by pulling downwards from the dispenser
2. Make 3 drilling marks then drill 3 mounting holes
3. Fix the mounting plate on the wall tightly
4. Open the battery cap then insert 4 pcs "AA" alkaline battery into the battery chamber, make sure battery is installed at the correct direction
5. Slide the dispenser down to the mounting plate
6. Open the top lid then fill in soap
7. Turn on the power switch
8. Place your hand under the sensor area to operate this dispenser, first time to use this dispenser you may need to operate dispenser by few times to pump the air out
9. Low battery indication: The red LED light blinks very fast to remind you change new batteries

MAINTENANCE

- Use non-granular, non-foaming liquid soap or hand sanitizer
- Please clean the dispenser only by dry towel
- This is not a waterproof product, please do not install it in shower room
- Clean the liquid outlet regularly to avoid clogging, clean the inside pump by filling warm water and operate it few times
- Long time no use please clean the soap tank and take out battery

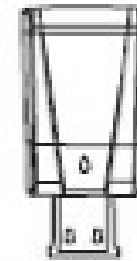

picture 1

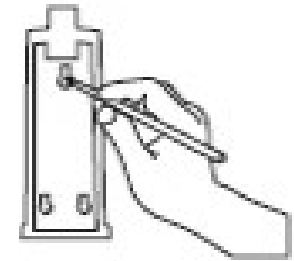

picture 2

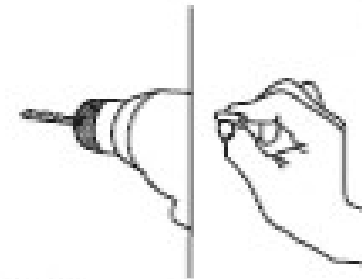

picture 3

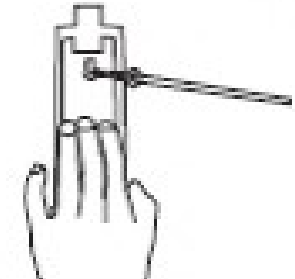

picture 4

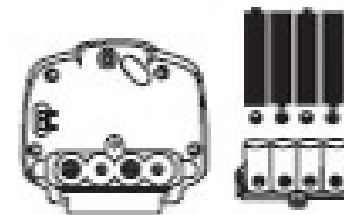

picture 5

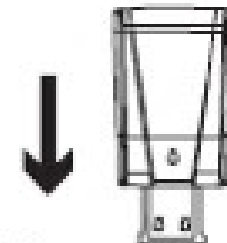

picture 6

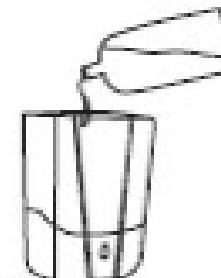

picture 7

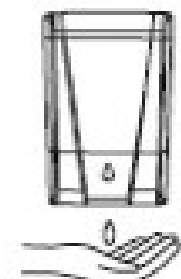

picture 8