

■ インターチェンジャブル注射器 ロック・メタル先

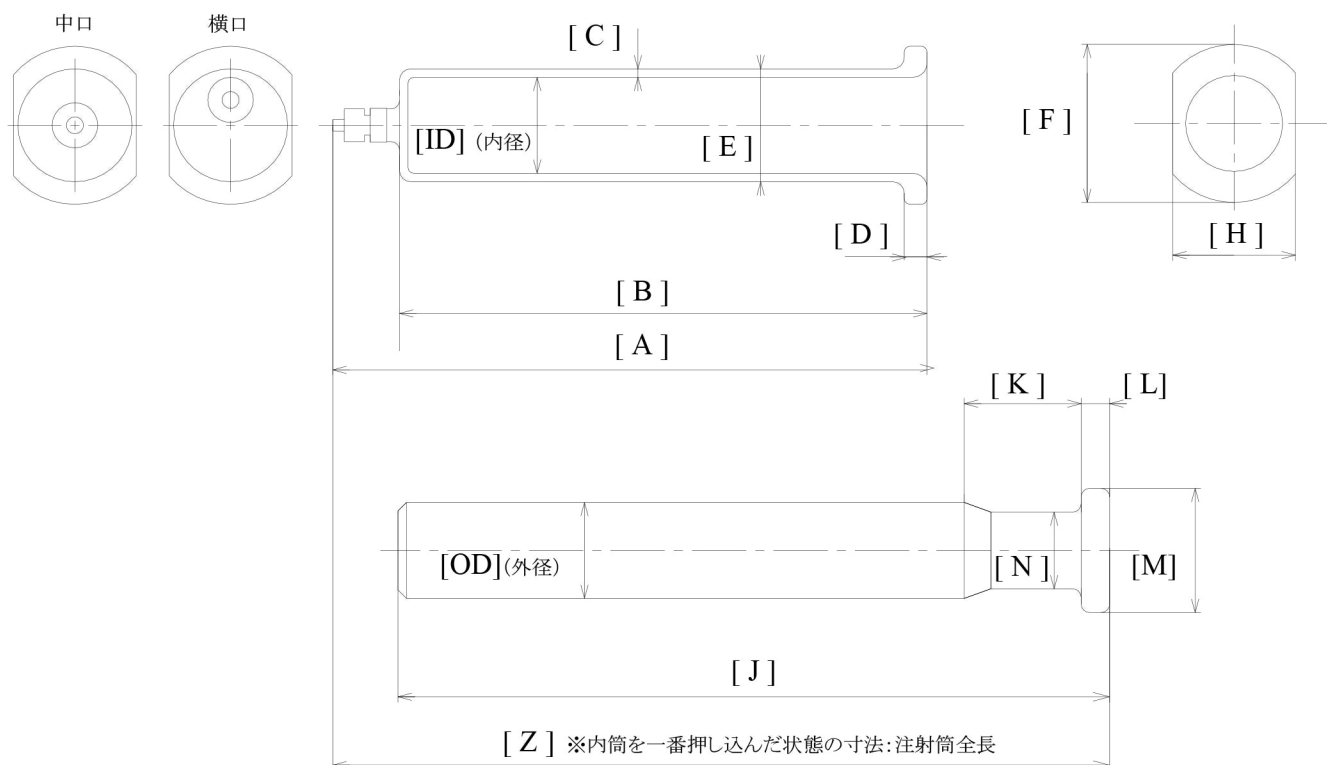

単位(mm)

容量	規格	A	B	C	D	E	ID	F	H	J	K	L	M	N	OD	Z
2-4985-01	1ml N	72	55.5	1.5	3.1	9.6	6.5	16.0	14.5	64.0	9.0	2.8	11.0	5.8	6.5	≒85
			57.0	1.7	3.6	10.2		17.0	15.5	66.0	9.7	3.8	12.0	6.9		
2-4985-02	2ml I	73	56.0	1.2	3.1	11.5	9.1	17.0	15.0	66.0	11.0	3.0	13.8	7.4	9.1	≒87
			57.5	1.5	3.6	12.1		19.0	17.0	68.0	11.7	4.0	14.8	8.5		
2-4985-03	2ml N	73	56.0	1.2	3.1	12.1	9.5	17.0	15.0	66.0	11.0	3.0	13.8	7.4	9.5	≒87
			57.5	1.5	3.6	12.7		19.0	17.0	68.0	11.7	4.0	14.8	8.5		
2-4985-04	3ml N	83	65.5	1.2	3.1	12.4	10.1	18.5	16.0	76.0	11.5	3.0	14.0	7.6	10.1	≒96
			67.0	1.4	3.6	13.0		19.5	17.0	78.0	13.0	4.0	15.0	8.8		
2-4985-05	5ml N	93	74.0	1.3	3.2	15.1	12.4	21.5	20.0	85.0	12.0	3.2	16.7	9.4	12.4	≒105
			75.5	1.5	3.7	15.7		23.0	21.0	87.0	13.5	4.2	17.9	11.0		
2-4985-06	10ml I	115	95.0	1.5	3.3	18.0	15.0	25.5	23.5	108.0	14.5	3.8	19.0	12.0	15.0	≒130
			97.0	1.7	4.0	18.6		27.0	24.5	110.0	16.0	4.9	20.5	13.8		
2-4985-07	10ml N	115	95.0	1.5	3.3	18.6	15.5	25.5	23.5	108.0	14.5	3.8	19.0	12.0	15.5	≒130
			97.0	1.7	4.0	19.2		27.0	24.5	110.0	16.0	4.9	20.5	13.8		
2-4985-08	20ml N/2	134	114.5	1.8	4.3	22.6	18.9	32.0	29.0	131.0	17.5	4.3	24.0	15.0	18.9	≒154
			116.5	2.0	5.1	23.3		32.8	29.8	133.0	19.0	5.8	25.5	16.8		
2-4985-09	20ml I	130	109.0	1.8	4.3	23.9	20.3	32.5	29.0	124.0	16.5	4.3	24.0	15.7	20.3	≒146
			111.0	2.0	5.1	24.6		34.0	31.0	126.0	18.0	5.8	25.5	17.5		
2-4985-10	20ml N	130	109.0	1.8	4.3	23.9	20.0	32.5	29.0	124.0	16.5	4.3	24.0	15.7	20.0	≒147
			111.0	2.0	5.1	24.6		34.0	31.0	126.0	18.0	5.8	25.5	17.5		
2-4985-11	30ml N	140	119.0	2.1	4.7	26.9	22.6	36.5	33.0	139.0	21.5	4.9	27.3	17.7	22.6	≒163
			121.5	2.3	5.5	27.7		38.5	35.0	142.0	23.5	6.1	28.8	19.5		
2-4985-12	50ml N	152	129.0	2.3	5.5	32.1	27.5	43.0	40.0	154.5	24.5	5.9	33.5	22.8	27.5	≒180
			132.0	2.6	6.5	33.1		44.5	42.0	157.5	26.0	7.5	35.0	24.6		
2-4985-13	100ml N	182	157.5	2.5	6.0	40.5	35.7	54.5	50.0	187.5	35.5	7.1	41.0	30.0	35.7	≒215
			161.0	2.7	7.0	41.9		56.5	52.5	190.5	38.1	9.2	43.0	32.5		

※ガラス製の為、上記寸法値と異なる場合がございます。